

RESOLUTION NO.309

FINAL RESOLUTION OF ANNEXATION OF STEVENSVILLE AIRPORT TO THE TOWN OF STEVENSVILLE, MONTANA

WHEREAS, the Mayor on behalf of the Town of Stevensville, as owner of 100% of the parcels and lands comprising the Stevensville Airport, has filed a Petition for Annexation to the Town, pursuant to MCA Title 7, Chapter 2, Part 46; and

WHEREAS, the Stevensville Planning and Zoning Board has reviewed the Petition for Annexation and Plan for Municipal Services and has recommended that the Stevensville Airport be annexed; and

WHEREAS, the Town Council adopted a "Resolution of Intent to Annex" the Stevensville Airport on November 21, 2012; and

WHEREAS, the annexation of the Stevensville Airport is in accordance with the Town of Stevensville's adopted Growth Policy; and

WHEREAS, the Town Council has determined that it is in the best interest of the Town of Stevensville that the Stevensville Airport be annexed.

NOW, THEREFORE, BE IT RESOLVED, by the Stevensville Town Council that the Stevensville Airport, legally described by the attachment hereto and shown on the accompanying land ownership chart and map, is hereby declared annexed and part of the Town of Stevensville, Montana.

Adopted this 20th day of December, 2012.

Approved:

Gene Mim Mack

Gene Mim Mack
Mayor

Attest:

Stacy Bartlett

Stacy Bartlett
Town Clerk

Return 10: town Clerk P.O. Box 30 Stevensville MT 59870

LEGAL DESCRIPTION
STEVENSVILLE AIRPORT PROPERTY

A TRACT OF LAND LOCATED IN SECTION 13 & 24, TOWNSHIP 9 NORTH, RANGE 20 WEST, SECTION 19 AND 30, TOWNSHIP 9 NORTH, RANGE 19 WEST, PRINCIPAL MONTANA MERIDIAN; RAVALLI COUNTY, MONTANA, AND BEING MORE PARTICULARLY DESCRIBED AS FOLLOWS:

BASIS OF BEARING:

BEARING IS GEODETIC, DERIVED FROM GPS OBSERVATIONS WITH SURVEY-GRADE RECEIVERS AND REFERENCED TO THE MERIDIAN AT NAD 83 NORTH LATITUDE 46°31'35.6" AND WEST LONGITUDE 114°03'10.8".

BEGINNING AT THE EAST QUARTER CORNER OF SAID SECTION 24, TOWNSHIP 9 NORTH, RANGE 20 WEST AND THE TRUE POINT OF BEGINNING;

THENCE, SOUTH 86°22'32" EAST A DISTANCE OF 578.05 FEET;
THENCE, SOUTH 03°28'51" WEST A DISTANCE OF 905.56 FEET;
THENCE, SOUTH 49°08'43" EAST A DISTANCE OF 221.19 FEET;
THENCE, SOUTH 46°33'55" WEST A DISTANCE OF 257.34 FEET;
THENCE, SOUTH 03°28'51" WEST A DISTANCE OF 97.22 FEET;
THENCE, NORTH 86°19'05" WEST A DISTANCE OF 568.71 FEET;
THENCE, NORTH 03°04'00" WEST A DISTANCE OF 33.47 FEET;
THENCE, NORTH 86°07'15" WEST A DISTANCE OF 55.38 FEET;
THENCE, NORTH 38°13'55" WEST A DISTANCE OF 614.47 FEET;
THENCE, SOUTH 52°05'13" WEST A DISTANCE OF 74.83 FEET;
THENCE, NORTH 43°27'58" WEST A DISTANCE OF 5135.51 FEET;
THENCE, NORTH 03°28'55" EAST A DISTANCE OF 22.66 FEET;
THENCE, NORTH 86°33'48" WEST A DISTANCE OF 823.03 FEET;
THENCE, NORTH 12°22'11" EAST A DISTANCE OF 133.05 FEET;
THENCE, NORTH 42°59'46" EAST A DISTANCE OF 250.85 FEET;
THENCE, NORTH 00°58'37" EAST A DISTANCE OF 418.25 FEET;
THENCE, NORTH 27°46'07" WEST A DISTANCE OF 128.85 FEET;
THENCE, NORTH 02°31'13" EAST A DISTANCE OF 78.43 FEET;
THENCE, NORTH 72°54'05" EAST A DISTANCE OF 145.72 FEET;
THENCE, NORTH 26°13'59" EAST A DISTANCE OF 215.29 FEET;
THENCE, NORTH 04°12'23" WEST A DISTANCE OF 139.37 FEET;
THENCE, SOUTH 86°33'51" EAST A DISTANCE OF 847.48 FEET;
THENCE, SOUTH 02°49'41" WEST A DISTANCE OF 555.90 FEET;
THENCE, SOUTH 51°21'09" EAST A DISTANCE OF 262.51 FEET;
THENCE, SOUTH 57°20'11" EAST A DISTANCE OF 267.48 FEET;
THENCE, SOUTH 11°12'14" EAST A DISTANCE OF 335.90 FEET;
THENCE, SOUTH 46°22'26" EAST A DISTANCE OF 226.54 FEET;
THENCE, SOUTH 16°24'35" WEST A DISTANCE OF 2.81 FEET;
THENCE, SOUTH 46°08'56" EAST A DISTANCE OF 11.29 FEET;
THENCE, SOUTH 86°34'13" EAST A DISTANCE OF 616.45 FEET;

THENCE, SOUTH 86°30'32" EAST A DISTANCE OF 1270.68 FEET;
THENCE, SOUTH 03°18'12" WEST A DISTANCE OF 1294.88 FEET;
THENCE, SOUTH 42°03'58" EAST A DISTANCE OF 31.41 FEET;
THENCE, SOUTH 86°32'04" EAST A DISTANCE OF 649.91 FEET;
THENCE, SOUTH 03°09'34" WEST A DISTANCE OF 1089.62 FEET;
THENCE, SOUTH 43°45'22" EAST A DISTANCE OF 354.25 FEET;
THENCE, SOUTH 86°18'26" EAST A DISTANCE OF 394.31 FEET TO THE POINT OF BEGINNING.

CONTAINS 174.00+/- ACRES SUBJECT TO ALL EASEMENTS OR DEDICATIONS, EXISTING OR OF RECORD.

THE AIRPORT BOUNDARY ALSO INCLUDES LOTS 2 & 3 OF HILLTOP WEST SUBDIVISION.
CONTAINS 2.18 ACRES SUBJECT TO ALL EASEMENTS OR DEDICATIONS, EXISTING OR OF RECORD.

STEVENSVILLE AIRPORT LAND OWNERSHIP

| PARCEL NO. | GRANTOR | GRANTEE | TYPE OF INTEREST | LAND RECORDS OF CLERK & RECORDER, RAVALLI COUNTY, MONTANA | | | | | | |
|--|--|----------------------|------------------|---|----------|-----------|------|------|------------------------|--|
| | | | | ACRES | DATE | DOCUMENT | BOOK | PAGE | COS | |
| A | Ravalli County | Town of Stevensville | FEE | 93.79 | 3/2/80 | | 154 | 861 | 609416R | |
| C1 | Roy B. Sawhill | Town of Stevensville | FEE | 11.43 | 4/27/81 | | 158 | 11 | | |
| E | Marjorie I. Schwaderer | Town of Stevensville | FEE | 0.72 | 10/22/96 | | 220 | 325 | 5151R | |
| H | Douglas A. & Antonia J. Palmer | Town of Stevensville | FEE | 0.11 | 7/6/94 | Parcel 7B | 210 | 421 | 5152R | |
| I | Jack D. & Cecelie K. Flicher | Town of Stevensville | FEE | 7.19 | 12/4/96 | | 220 | 326 | 2986 | |
| J | Brian J. & Gwyneth J. Sorenson | Town of Stevensville | FEE | 4.31 | 11/30/00 | 472874 | | | 4427 | |
| K | Carl Saunders | Town of Stevensville | FEE | 25.47 | 7/24/01 | 482423 | | | 4427 | |
| L | Donald J. Sawhill, Wallace C. Sawhill, Roy B. Sawhill, Charles F. Sawhill, Robert H. Sawhill | Town of Stevensville | FEE | 31.02 | 10/15/08 | 521846 | | | 609416R | |
| N | Bill M. Brown & Sandra S. Brown | Town of Stevensville | FEE | 1.00 | 3/7/02 | 492641 | | | Hilltop West Plat #576 | |
| O | Cass Family Trust | Town of Stevensville | FEE | 1.18 | 9/18/02 | 502255 | | | Hilltop West Plat #576 | |
| Total Acres Owned | | | | 176.22 | | | | | | |
| Stevensville Airport – Town of Stevensville | | | | | | | | | | |

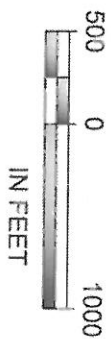
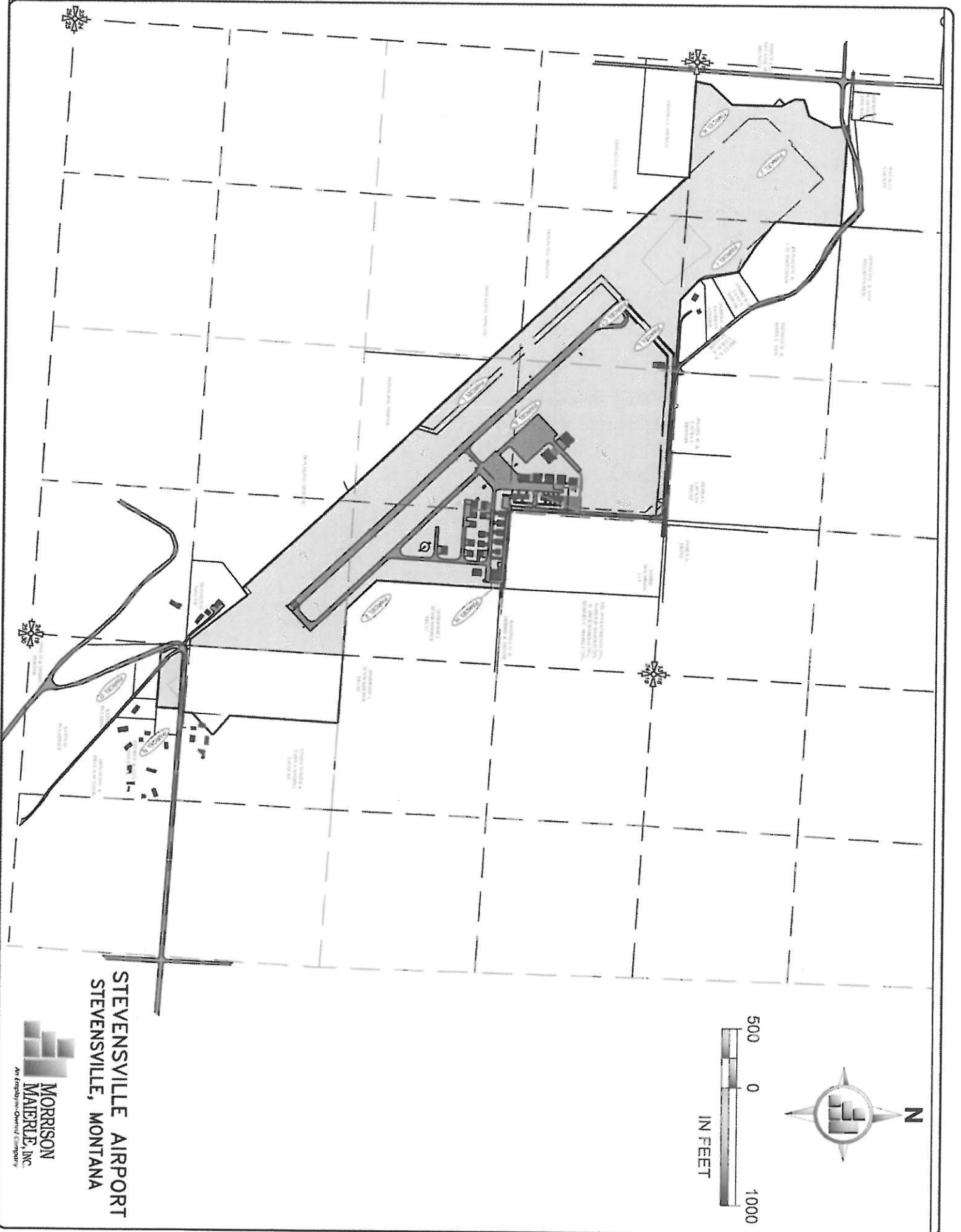

STEVENSVILLE AIRPORT
STEVENSVILLE, MONTANA



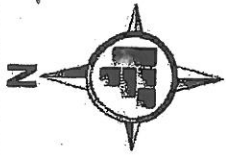

STEVENSVILLE AIRPORT STEVENSVILLE, MONTANA

